



300 Series Turret  
HD Analog Surveillance Camera

# **Installation & Operation Manual**

## Installation

Before you start, ensure that the device is in good condition and all the assembly parts are included.

- Make sure that all equipment is powered off during installation.
- Ensure the wall is strong enough to hold three times the weight of the camera and the mount.
- If the mounting surface is cement, use the included expansion screws to install the camera. If mounting to a wood surface, use self-tapping wood screws (not included) to secure the camera.
- If the product does not function properly, please contact technical support. Do not disassemble the camera for repair or maintenance.

## ..... **Wiring Advisory** .....

We recommend installing with RG-59 or RG-6 cabling with two-wire power (either regular or siamese). This provides better performance over distance than using traditional category cable with baluns.

For more details on the cameras or cables, see the product page at [SnapAV.com](http://SnapAV.com).

## Box Contents

- Camera
- Mounting bracket
- Self-adhesive mounting template
- 3 x wall anchors with screws
- 3mm hex wrench

## Other Required Equipment

Aside from the contents of this box, you will need

- Phillips screwdriver
- Power source: 12V DC

## Overview

Before installing, familiarize yourself with the parts of your camera.

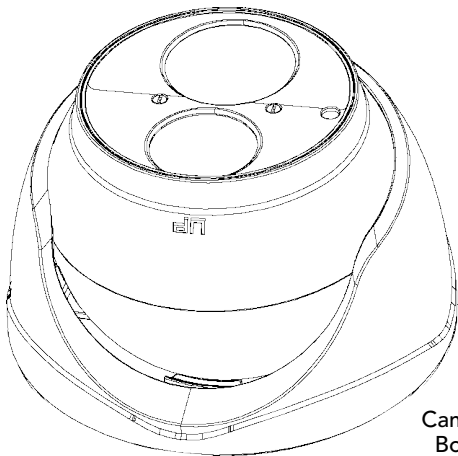

Camera  
Body

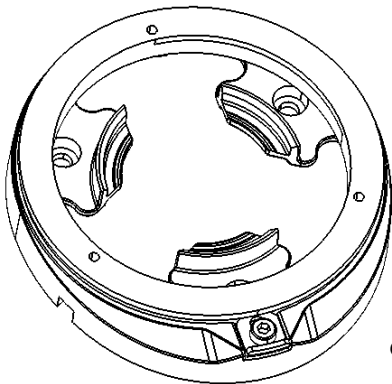

Camera  
Base

## Cables

- The black BNC cable: 960H video connection.
- The gray BNC cable: HD-TVI connection.
- Standard gray cable: power.
- The thin, twin wires (black and white) are used to select CVBS or HD-TVI signal.

## Prepare for Installation

1. Drill a cable hole and pilot holes for your screws in the ceiling, using the supplied template shown.

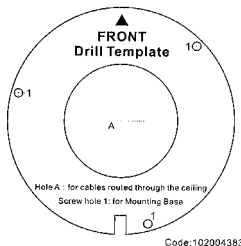

2. Select which BNC cable you are going to use. Wrap the unused BNC head in electrical tape to avoid cross-connection.

3. If using CVBS, cross-connect the two thin wires to activate the CVBS signal. Otherwise, wrap the wires separately to avoid cross-connection.
4. Loosen the locking hex screw on the base and remove it from the camera housing.

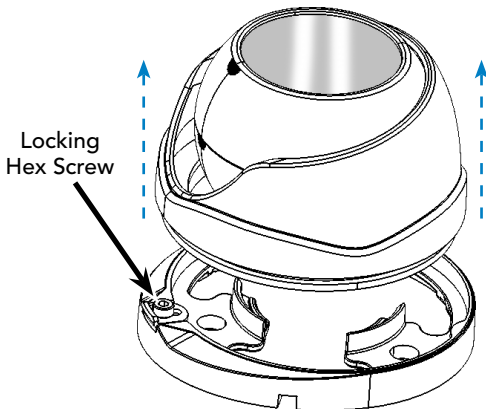



## ||||| **Install the Camera** |||||

5. Attach the base of the camera to the ceiling and secure it with screws.
6. Route the cables through the cable hole. Note that the base provides extra space between the camera and the ceiling for wire management.

7. Insert the camera into the base, making sure the open area of the housing is pointed in the direction you want the camera to aim. Tighten the locking hex screw to secure the camera in place.

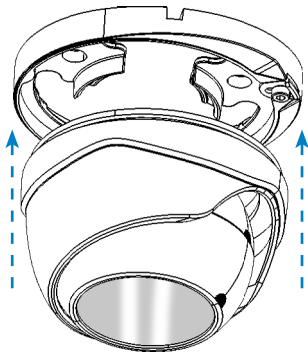

8. Connect the power and video cables.

## Adjust the Camera

1. Manually adjust the camera to get an optimum angle, being careful not to touch the lens. The camera is free-floating for perfect pan and tilt control.
2. Adjust the camera's zoom and focus using the screws on the camera face.

## Support

If you need help, email [support@SnapAV.com](mailto:support@SnapAV.com). For information, instructional videos, support documentation, or ideas, visit our website.

### 5-Year Limited Warranty

This Luma Surveillance™ product has a 5-Year Limited Warranty. This warranty includes parts and labor repairs on all components found to be defective in material or workmanship under normal conditions of use. This warranty shall not apply to products that have been abused, modified or disassembled. Products to be repaired under this warranty must be returned to a designated service center with an assigned return authorization (RA) number. Contact technical support for an RA number.

Copyright ©2015 by SnapAV. All rights reserved. SnapAV, Luma Surveillance, and all related marks and images are trademarks or registered trademarks of SnapAV.

Version 150910-0843